

# edilportale® TOUR 2019

L'edilizia dei prossimi 10 anni



#edilportaletour2019

TRENTO, 15 MAGGIO 2019

**L'EDILIZIA DEI PROSSIMI 10 ANNI...**

**Carlo Zanchetta**

## D.M. MIT 560/2017

Art. 1 finalità

Art. 2 definizioni

Art. 3 adempimenti preliminari delle stazioni appaltanti

Art. 4 interoperabilità

Art. 5 utilizzo facoltativo

Art. 6 tempi di introduzione obbligatoria

Art. 7 capitolato

Art. 8 commissione di monitoraggio

Art. 9 entrata in vigore

**ADOZIONE**

# L'EDILIZIA DEI PROSSIMI 10 ANNI

- » 100 milioni € 1/1/2019
  - » 50 milioni € 1/1/2020
  - » 15 milioni € 1/1/2021
- 
- » **NESSUNA DISTINZIONE  
PER COMPLESSITÀ\*** soglia comunitaria  
(5.548.000 €) 1/1/2022
  - » 1 milione € 1/1/2023
  - » tutte le opere 1/1/2025

## DA SUBITO

Art. 5 utilizzo facoltativo

Art. 6 tempi di introduzione obbligatoria



# ADOZIONE

\*(art. 2, comma 1-e)

O elevato contenuto tecnologico

O significativa interconnessione degli aspetti architettonici, strutturali e tecnologici

O rilevanti difficoltà realizzative dal punto di vista impiantistico-tecnologico

# L'EDILIZIA DEI PROSSIMI 10 ANNI

parallab  
PH.D ING CARLO ZANCHETTA

**RAGIONE ...**

# L'EDILIZIA DEI PROSSIMI 10 ANNI

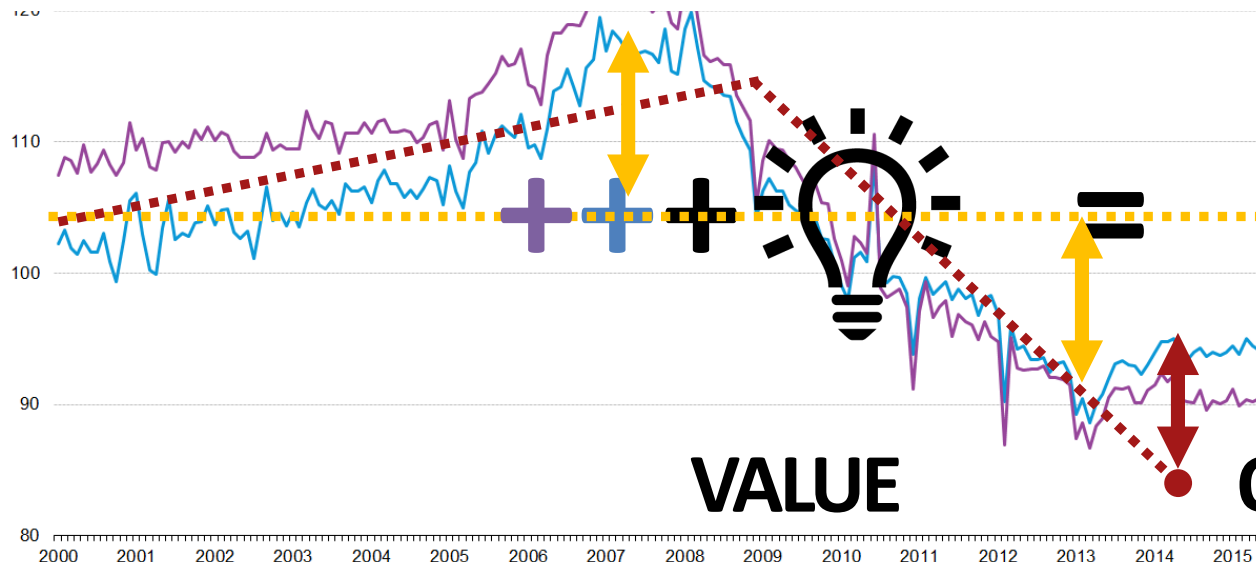
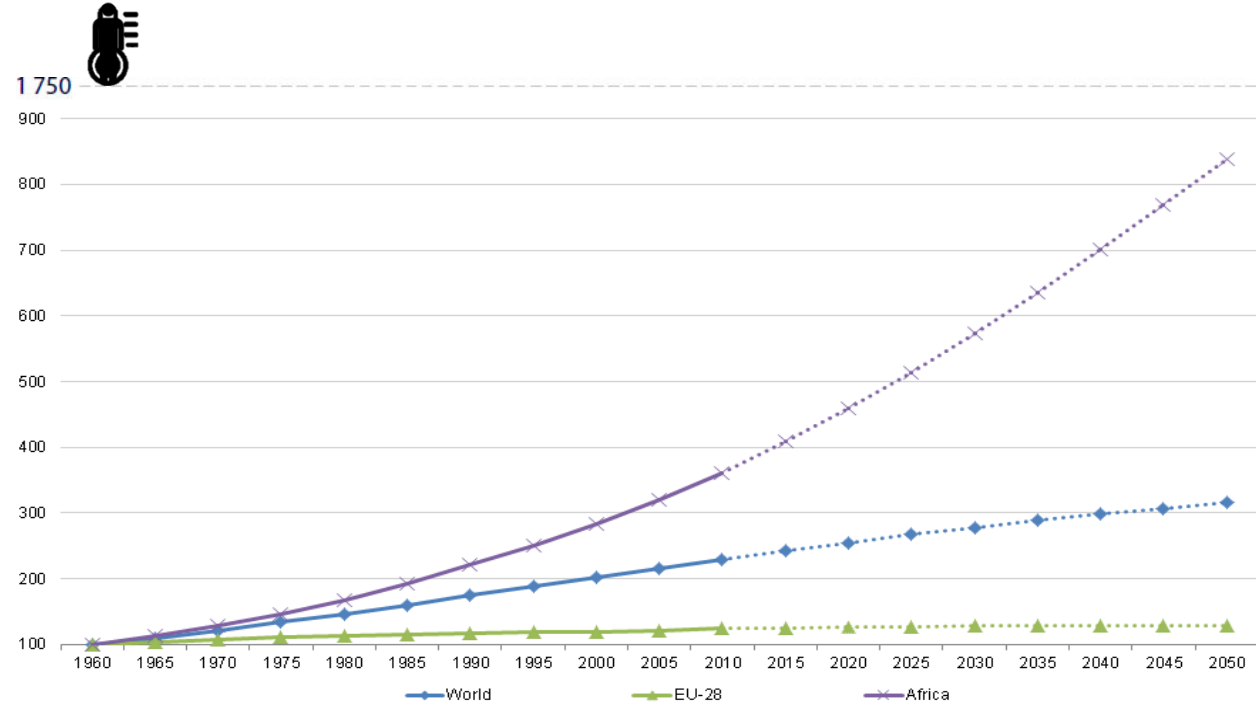

VALUE

QUALITY

COSTS



# L'EDILIZIA DEI PROSSIMI 10 ANNI

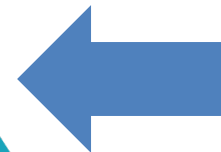
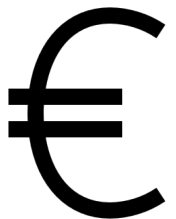
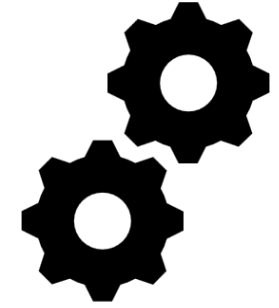
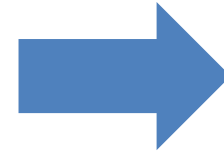
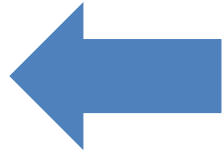

# L'EDILIZIA DEI PROSSIMI 10 ANNI

parallab  
PH.D ING CARLO ZANCHETTA

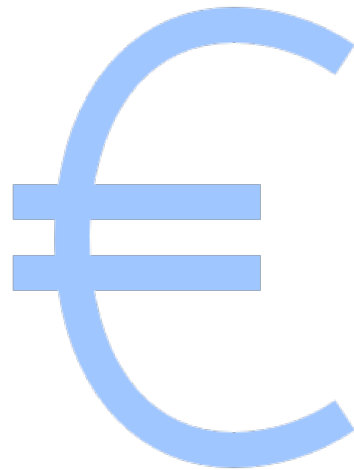

# L'EDILIZIA DEI PROSSIMI 10 ANNI

UK

Lower costs

33%

reduction in the initial cost of construction and the whole life cost of built assets

Lower emissions

50%

reduction in greenhouse gas emissions in the built environment

Faster delivery

50%

reduction in overall time, from inception to completion, for newbuild and refurbished assets

Improvements in exports

50%

reduction in the trade gap between total exports and total imports for construction products and materials

INFORMATION

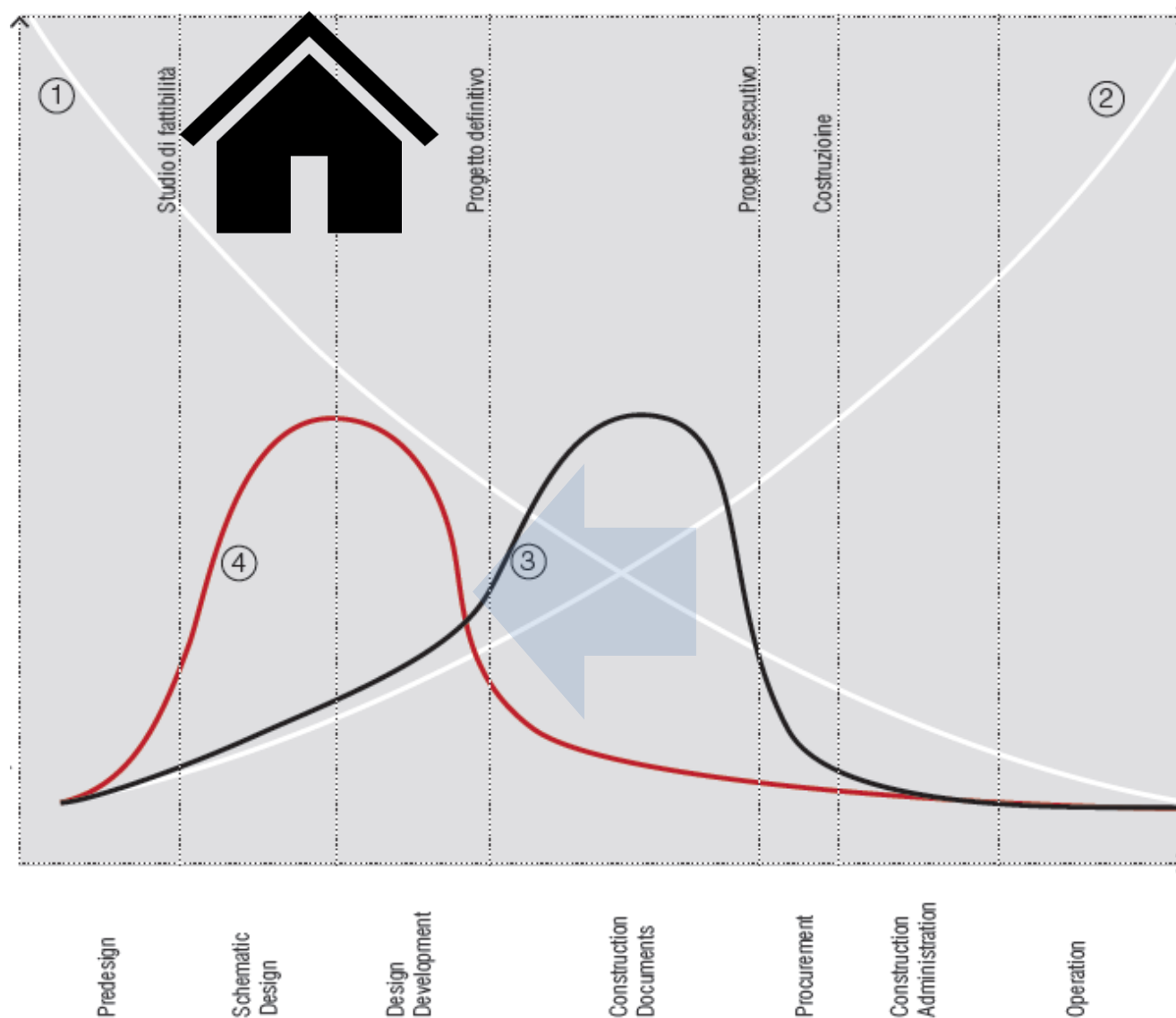



# L'EDILIZIA DEI PROSSIMI 10 ANNI



**COORDINATION -33%**

**BIM**

1

5

200

**CAPITAL COST    COST IN USE    COST TO BUSINESS**

# L'EDILIZIA DEI PROSSIMI 10 ANNI

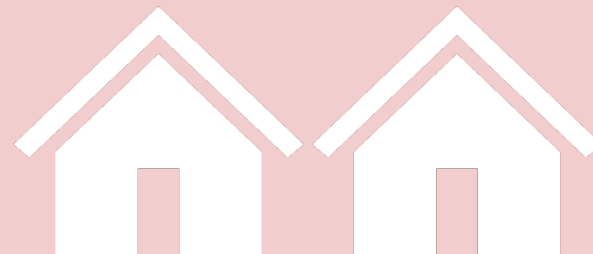

**SUSTAINABILITY – 35%**

**BIM?**

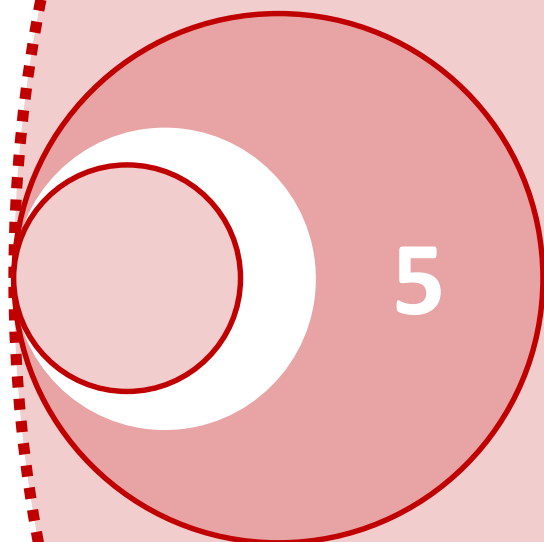

**200**

# L'EDILIZIA DEI PROSSIMI 10 ANNI

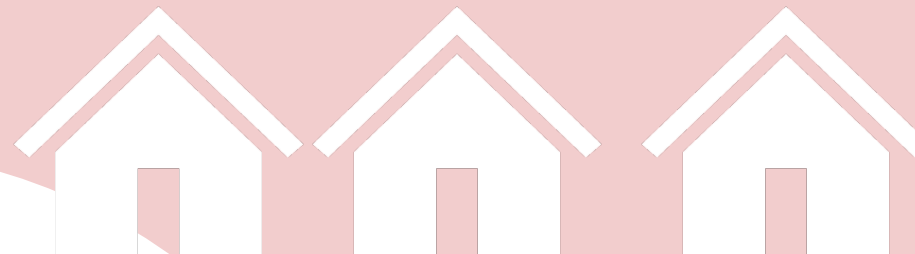

## PRODUCTIVITY + 18%

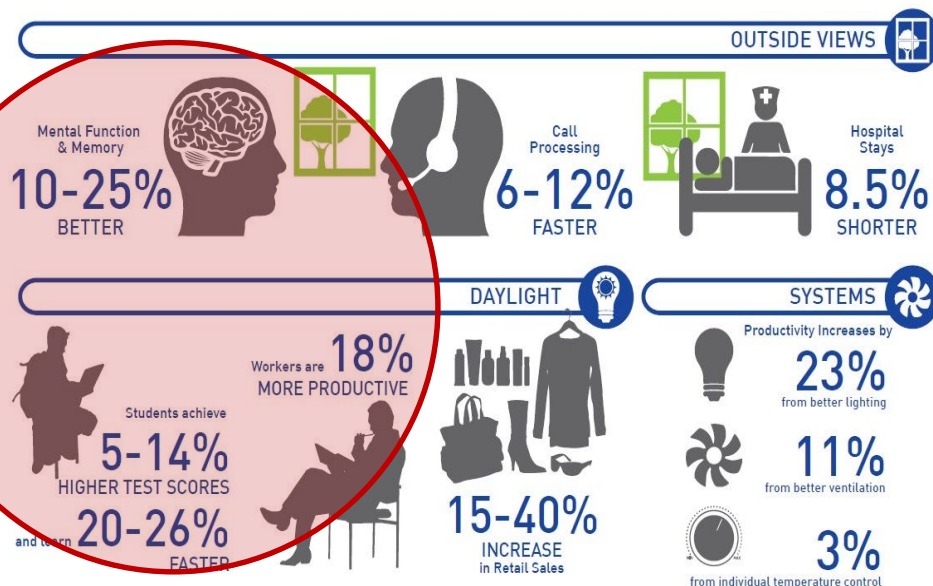

BIM?

200

# L'EDILIZIA DEI PROSSIMI 10 ANNI

## DIGITALE

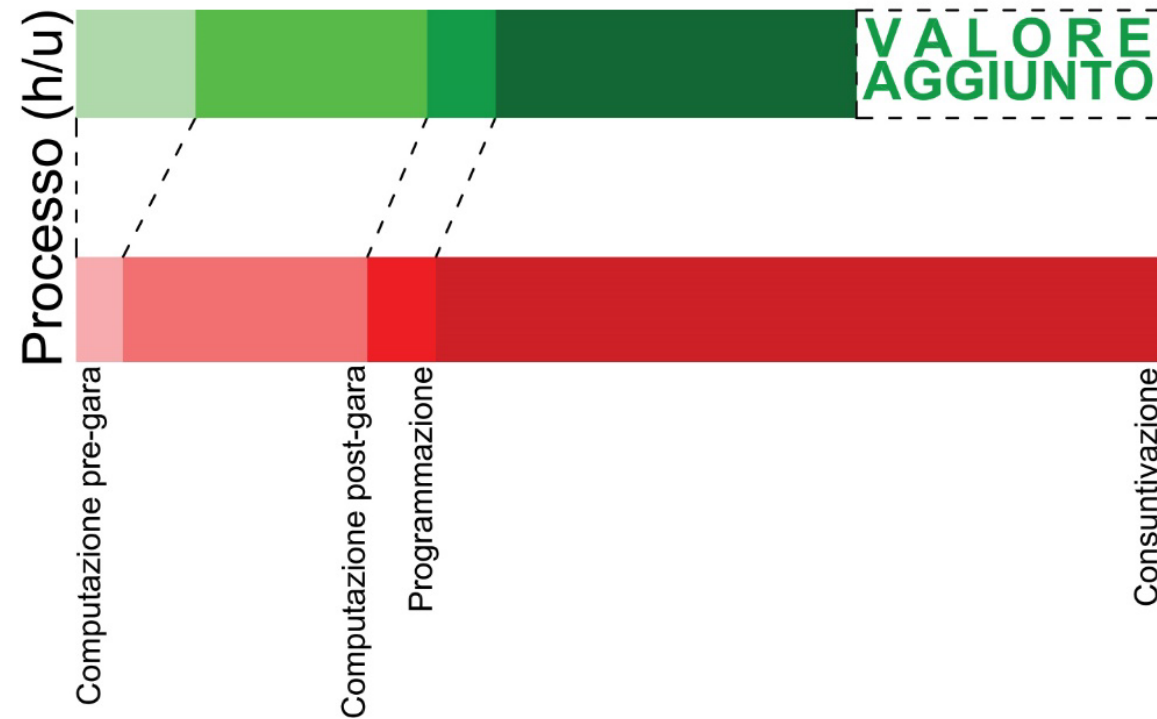
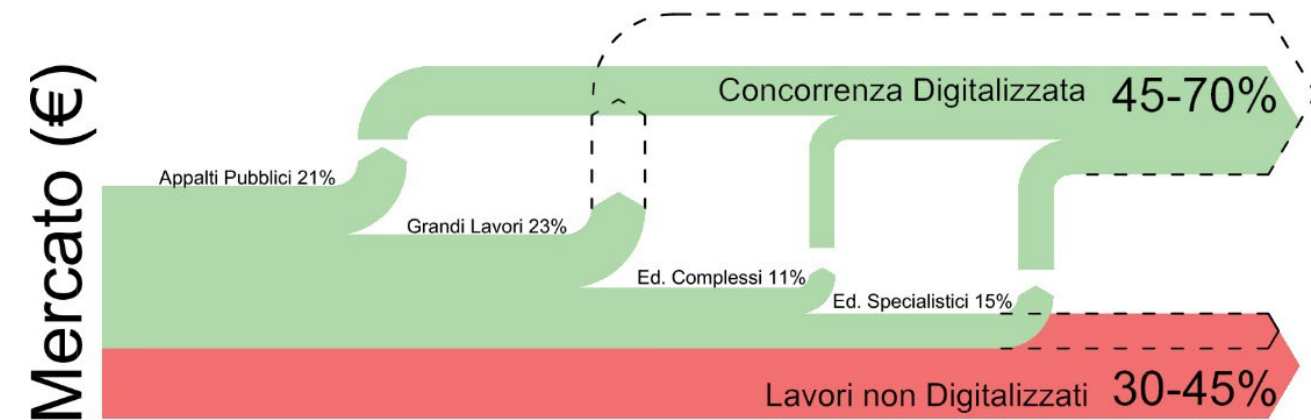

## ANALOGICO

# L'EDILIZIA DEI PROSSIMI 10 ANNI

# DIGITALE

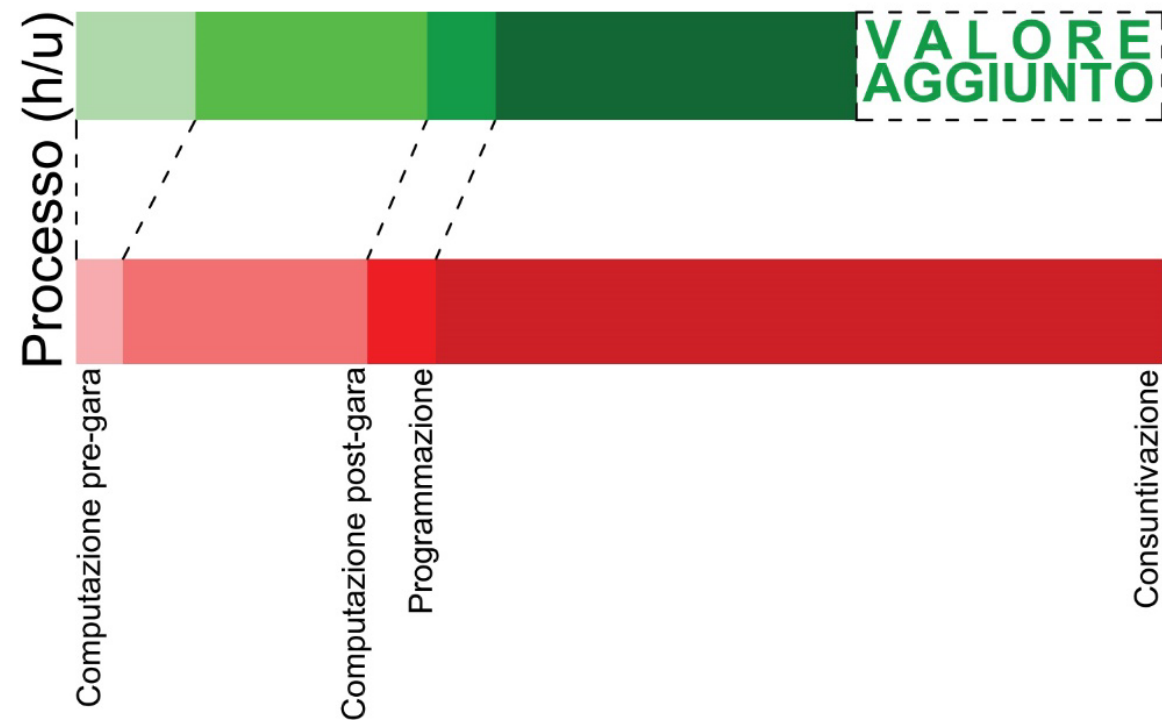
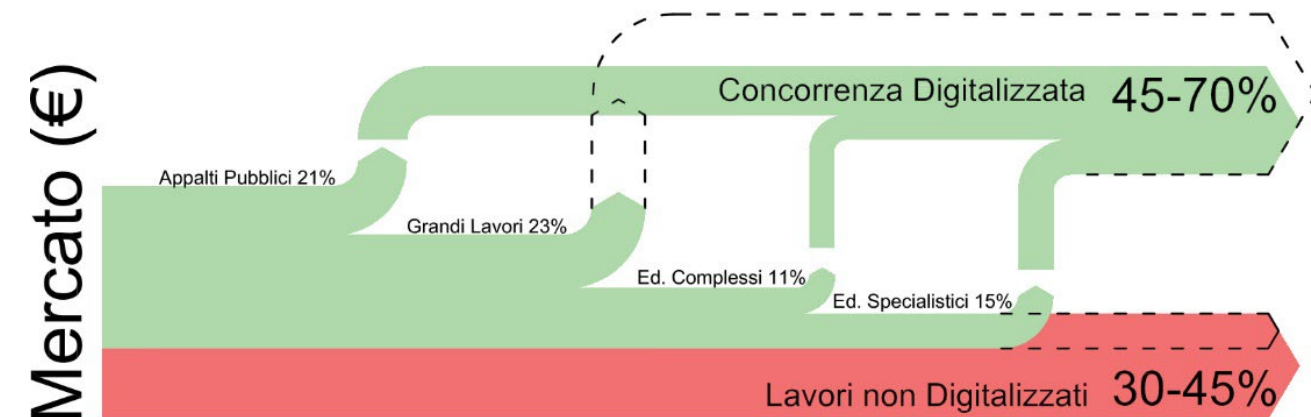

# ANALOGICO

# L'EDILIZIA DEI PROSSIMI 10 ANNI

parallab  
PH.D ING CARLO ZANCHETTA

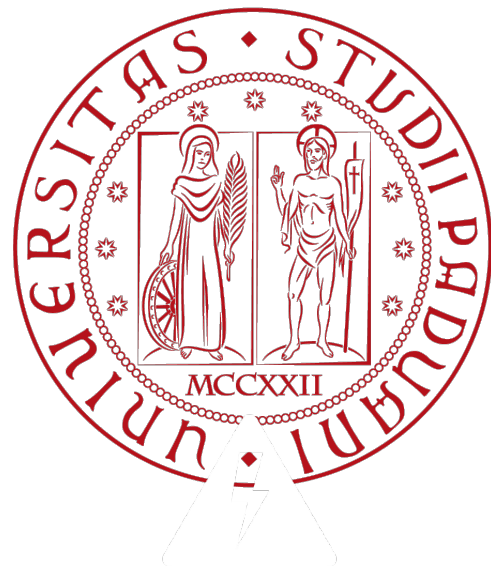

≈ 21000 LOCALI

# L'EDILIZIA DEI PROSSIMI 10 ANNI

parallelab  
PH.D ING CARLO ZANCHETTA

The image shows a Microsoft Excel spreadsheet with a grid of data. The columns are labeled A through G. The rows contain numerical IDs in column A, descriptions in column E, and categories in column G. The spreadsheet is titled '00135' in the top right corner of the grid. The interface includes the standard Excel ribbon with tabs for File, Home, Inserisci, Layout di pagina, Formule, Dati, Revisione, Visualizza, and a search bar. The status bar at the bottom indicates 'Pronto' and '100%' zoom.

A	B	C	D	E	F	G
419	00190			0	EDIFICIO DI SCIENZE FARMACEUTICHE	EX CHIMICA FARMACEUTICA - FARMACIA
420	00180			0	EDIFICIO "G. GALILEI" - FISICA	FISICA
421	00180			0	EDIFICIO "G. GALILEI" - FISICA	FISICA
422	00180			0	EDIFICIO "G. GALILEI" - FISICA	FISICA
423	00170			0	EDIFICIO DI FISIOLOGIA E CHIMICA ORGANICA	EX CHIMICA BIOLOGICA E FISIOLOGIA
424	00170			0	EDIFICIO DI FISIOLOGIA E CHIMICA ORGANICA	EX CHIMICA BIOLOGICA E FISIOLOGIA
425	00160	A1	A	1 > A1	PALAZZETTO EX DISEGNO	ANTROPOLOGIA
426	00150			0	PALAZZETTO COSTRUZIONI MARITTIME	COSTRUZIONI MARITTIME E GEOTECNICA
427	00150			0	PALAZZETTO COSTRUZIONI MARITTIME	COSTRUZIONI MARITTIME E GEOTECNICA
428	00150			0	PALAZZETTO COSTRUZIONI MARITTIME	COSTRUZIONI MARITTIME E GEOTECNICA
429	00140	G1		0	COMPLESSO INGEGNERIA MECCANICA	COMPLESSO "MACCHINE"
430	00140	G1		0	COMPLESSO INGEGNERIA MECCANICA	COMPLESSO "MACCHINE"
431	00140	G1		0	COMPLESSO INGEGNERIA MECCANICA	COMPLESSO "MACCHINE"
432	00140	G1		0	COMPLESSO INGEGNERIA MECCANICA	COMPLESSO "MACCHINE"
433	00140	G1		0	COMPLESSO INGEGNERIA MECCANICA	COMPLESSO "MACCHINE"
434	00140	G1		0	COMPLESSO INGEGNERIA MECCANICA	COMPLESSO "MACCHINE"
435	00140	G1		0	COMPLESSO INGEGNERIA MECCANICA	COMPLESSO "MACCHINE"
436	00140	G1		0	COMPLESSO INGEGNERIA MECCANICA	COMPLESSO "MACCHINE"
437	00140	G1		0	COMPLESSO INGEGNERIA MECCANICA	COMPLESSO "MACCHINE"
438	00135			0	EDIFICIO EX FISICA TECNICA	
439	00135			0	EDIFICIO EX FISICA TECNICA	
440	00135			0	EDIFICIO EX FISICA TECNICA	
441	00130			0	COMPLESSO INGEGNERIA	INGEGNERIA VECCHIA
442	00130			0	COMPLESSO INGEGNERIA	INGEGNERIA VECCHIA
443	00130			0	COMPLESSO INGEGNERIA	INGEGNERIA VECCHIA
444	00125			0	EDIFICIO DI MICROBIOLOGIA	
445	00125			0	EDIFICIO DI MICROBIOLOGIA	
446	00125			0	EDIFICIO DI MICROBIOLOGIA	
447	00125			0	EDIFICIO DI MICROBIOLOGIA	
448	00120			0	COMPLESSO ISTITUTI ANATOMICI	
449	00120			0	COMPLESSO ISTITUTI ANATOMICI	
450	00120			0	COMPLESSO ISTITUTI ANATOMICI	
451	00120			0	COMPLESSO ISTITUTI ANATOMICI	
452	00115			0	PALAZZO EX RIZZATO	
453	00115			0	PALAZZO EX RIZZATO	
454	00114			0	PROPRIETA' JONCH	
455	00113			0	PALAZZO LUZZATO DINA IN BUZZACCARINI	
456	00113			0	PALAZZO LUZZATO DINA IN BUZZACCARINI	

# L'EDILIZIA DEI PROSSIMI 10 ANNI

parallab  
PH.D ING CARLO ZANCHETTA

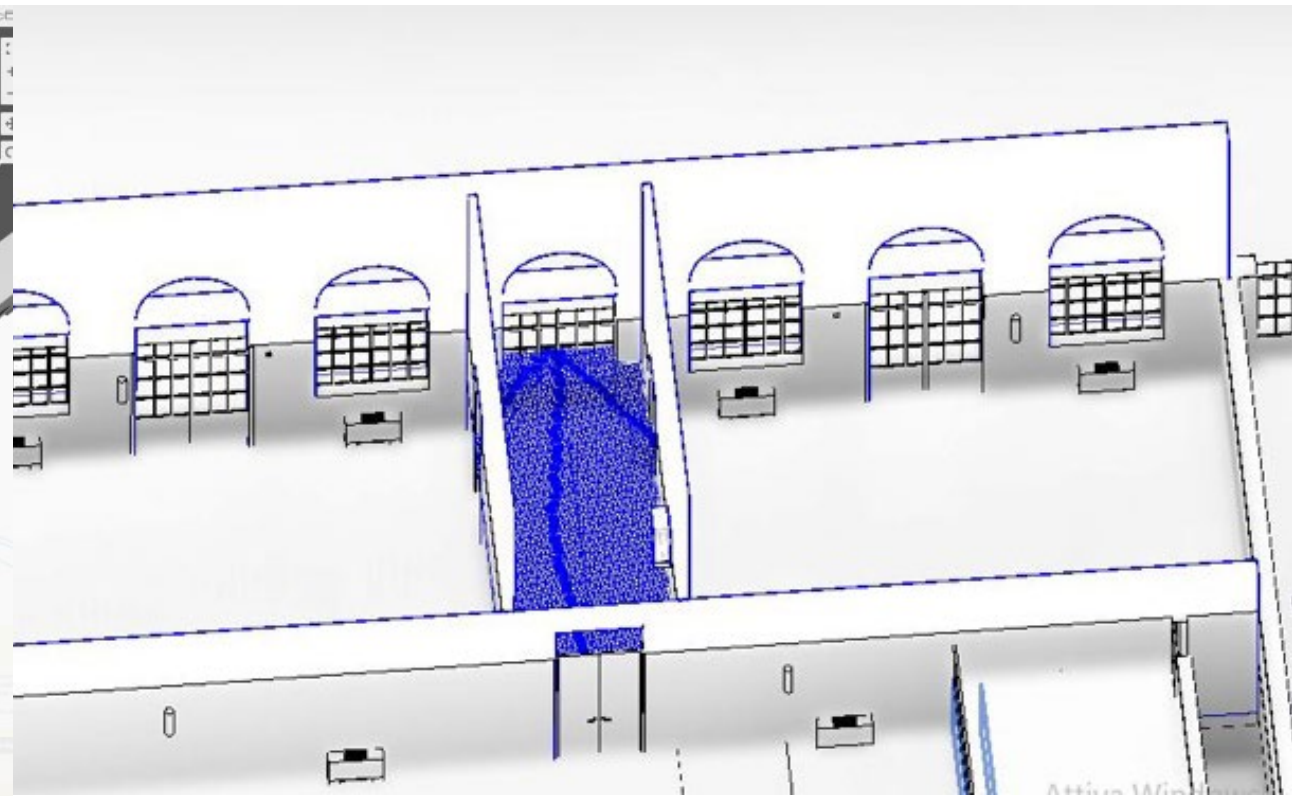
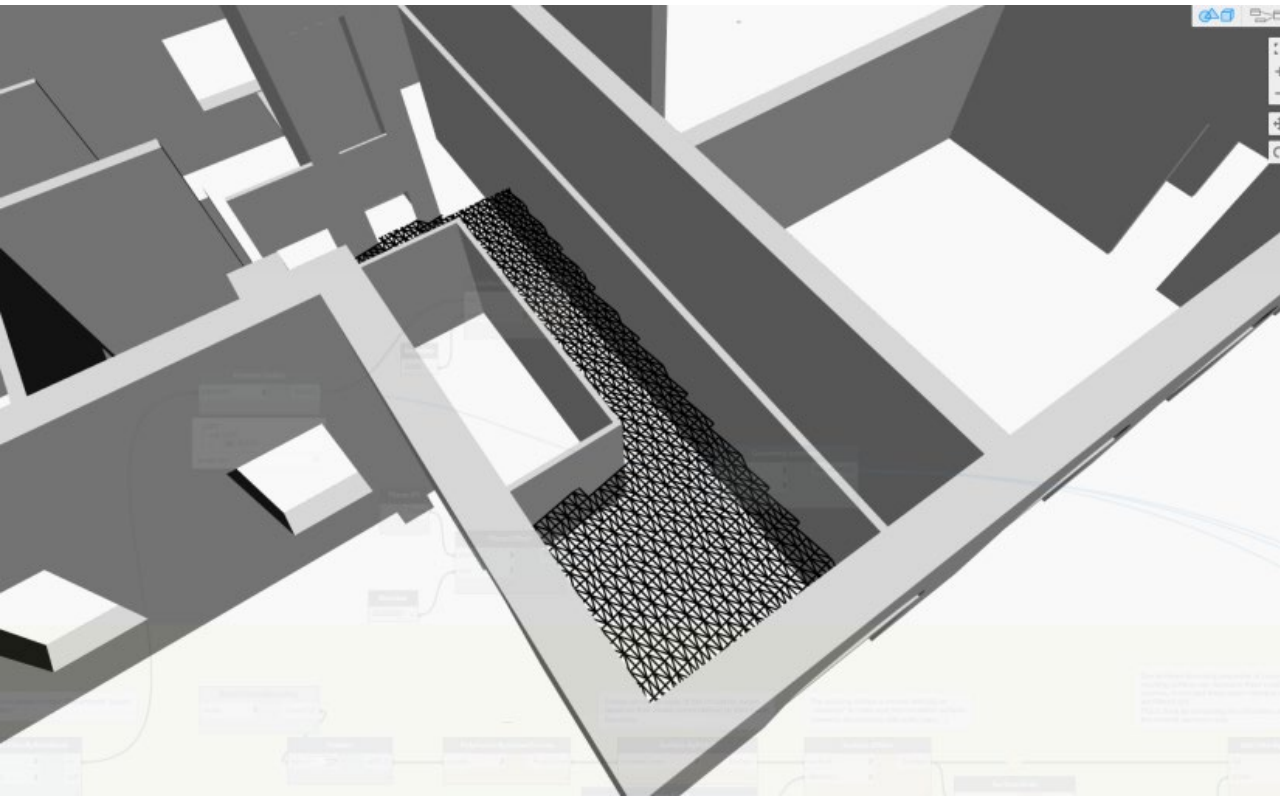





# L'EDILIZIA DEI PROSSIMI 10 ANNI

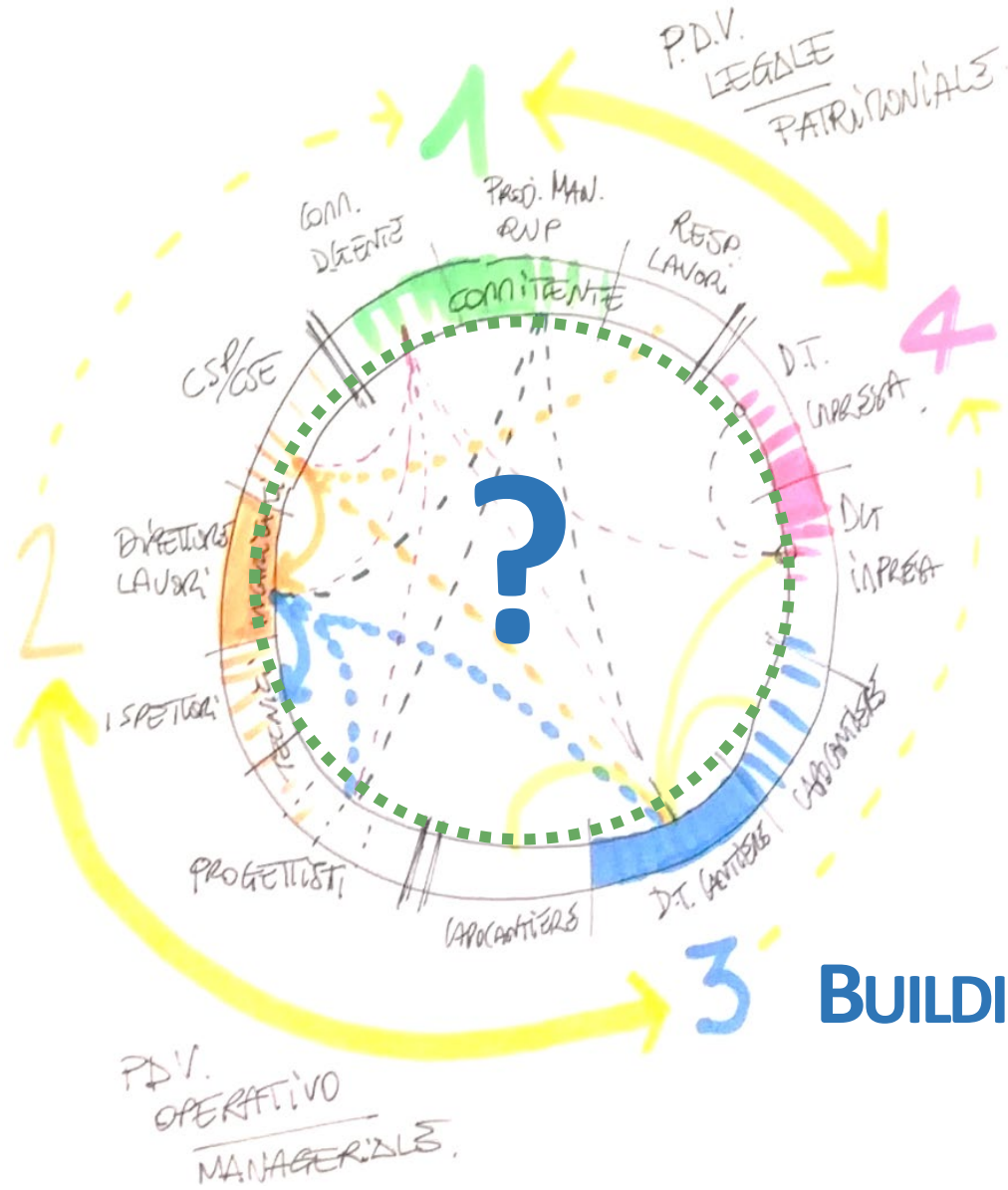

## BUILDING INFORMATION MODELING AND MANAGEMENT

# L'EDILIZIA DEI PROSSIMI 10 ANNI

## BIM IT!

RACCOGLIE L'INFORMAZIONE EDILIZIA NEL BIM

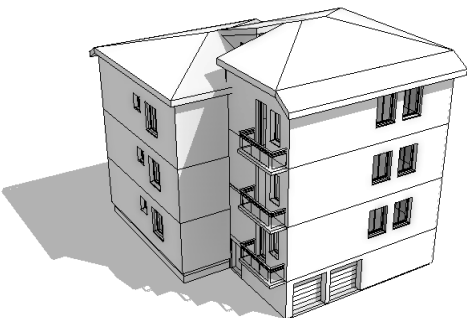

## 5D

COLLEGA AL BIM QUANTITÀ E COSTI

Dimensions	
Sporgenza avanzale	15.00
Height	150.00
Altezza soglia	80.00
Width	120.00
Rough Width	
Rough Height	
Analytical Properties	

## 4D

COLLEGA AL BIM TEMPI E COSTI

ID	Nome	Quantità	Costo	Unità
370000	ATEX, Lato da tempo	100	10000000	17-06-2008/18
370001	Capote	100	10000000	17-06-2008/18
370002	pano cemento A	100	10000000	17-06-2008/18
370003	pano cemento B	100	10000000	17-06-2008/18
370004	pano cemento C	100	10000000	17-06-2008/18
370005	pano cemento D	100	10000000	17-06-2008/18
370006	pano cemento E	100	10000000	17-06-2008/18
370007	pano cemento F	100	10000000	17-06-2008/18
370008	pano cemento G	100	10000000	17-06-2008/18
370009	pano cemento H	100	10000000	17-06-2008/18
370010	pano cemento I	100	10000000	17-06-2008/18
370011	pano cemento J	100	10000000	17-06-2008/18
370012	pano cemento K	100	10000000	17-06-2008/18
370013	pano cemento L	100	10000000	17-06-2008/18
370014	pano cemento M	100	10000000	17-06-2008/18
370015	pano cemento N	100	10000000	17-06-2008/18
370016	pano cemento O	100	10000000	17-06-2008/18
370017	pano cemento P	100	10000000	17-06-2008/18
370018	pano cemento Q	100	10000000	17-06-2008/18
370019	pano cemento R	100	10000000	17-06-2008/18
370020	pano cemento S	100	10000000	17-06-2008/18

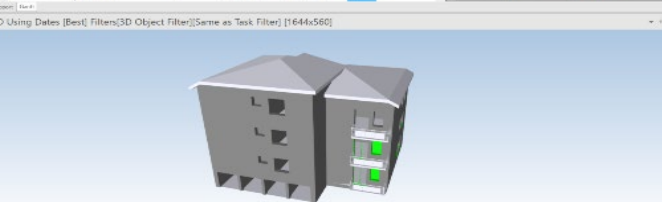

## 4D (t)

PORTA IN CANTIERE IL BIM

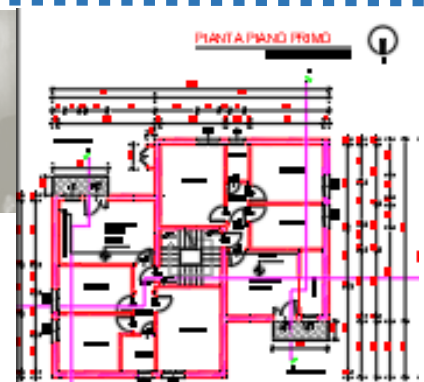

larghezza	altezza	mq	1,20
0,80	1,50	mq	1,20
1,20	1,50	mq	1,80
1,20	1,50	mq	1,80
1,20	1,50	mq	1,80
		mq	
		mq	
0,80	0,80	mq	0,64
		mq	
			7,24

Settimane di lavoro	1	2	3	4	5	6	7	8	9	10	11
ALLESTIMENTO CANTIERE											
INSTALLAZIONE GRU A TORRE											
MONTAGGIO E SMONTAGGIO PONTEGGI											
DEMOLIZIONI											
OPERE IN MURATURA											
INCAMICIATURA PILASTRI											
RINFORZO CON RETE FIBRORINFORZATA											
POSA CONTROSOFFITTI											
MASSETTI, SOTTOFONDI, PAVIMENTI											
CAPPOTTO ESTERNO											
RASATURA E PITTURA											
COIBENTAZIONE COPERTURA											
OPERE LATTONIERE											
OPERE SERRAMENTISTA											
IMPIANTI MECCANICI INTERNI											



PROGETTAZIONE

GARA

PROGRAMMAZIONE

ESECUZIONE

BUILDING INFORMATION MODELING AND MANAGEMENT

# L'EDILIZIA DEI PROSSIMI 10 ANNI

parallelab  
PH.D ING CARLO ZANCHETTA

The screenshot displays the Synchro software interface for project management. The main window is titled "ATER\_via da Ionigo.spx - Synchro". The interface includes a menu bar (File, Configure, Plan, Assign Resources, 3D, 4D Review, Analyse, Reports, Windows, Navigator), a toolbar with various icons for navigation and analysis, and a central workspace. The workspace is divided into three main sections: a 3D Objects list on the left, a Gantt chart in the middle, and a Task Properties panel on the right.

**3D Objects List:**

ID	Name	Duration	Start	Finish	3D Re...
1	ATER_via da Ionigo	14d	09:00 10/05/18	17:00 29/05/18	(117)
2	Cappotto	7d	09:00 10/05/18	17:00 18/05/18	(28)
4	piano rialzato A	1d	09:00 10/05/18	17:00 10/05/18	4
6	piano primo A	1d	09:00 11/05/18	17:00 11/05/18	4
8	piano secondo A	1d	09:00 14/05/18	17:00 14/05/18	4
3	piano terra	1d	09:00 15/05/18	17:00 15/05/18	4
5	piano rialzato B	1d	09:00 16/05/18	17:00 16/05/18	4
7	piano primo B	1d	09:00 17/05/18	17:00 17/05/18	4
9	piano secondo B	1d	09:00 18/05/18	17:00 18/05/18	4
10	Serramenti	7d	09:00 21/05/18	17:00 29/05/18	(89)
12	piano rialzato A	1d	09:00 21/05/18	17:00 21/05/18	13
14	piano primo A	1d	09:00 22/05/18	17:00 22/05/18	13
16	piano secondo A	1d	09:00 23/05/18	17:00 23/05/18	13
11	piano terra	1d	09:00 24/05/18	17:00 24/05/18	8
13	piano rialzato B	1d	09:00 25/05/18	17:00 25/05/18	13

**Gantt Chart:** The Gantt chart shows the project schedule from May 2018. It includes tasks for "Cappotto", "piano rialzato A", "piano primo A", "piano secondo A", "piano terra", "piano rialzato B", "piano primo B", "piano secondo B", and "Serramenti".

**Task Properties Panel:**

- General: ID ST00080, Name piano rialzat..., Calendar Ater PD, Task Type Work, URL, Comments, GUID 7868503B-2...
- Progress: Status Planned, Progress T... Automatic, % Complete 0.00
- Durations: Duration Ty... Fixed, Duration 1d, Planned Du... 1d, Remaining... 1d, Actual Durat... 0d, Duration At... 1d, BL Duration
- Start Dates: Start 09:00 10/05/18, Planned Start 09:00 10/05/18, Actual Start 09:00 10/05/18, BL Start
- Finish Dates: Finish 17:00 10/05/18, Planned Fin... 17:00 10/05/18, Estimated F... 17:00 10/05/18, Actual Finish 17:00 10/05/18, BL Finish
- Constraints: Constraint T... No Constrai..., Constraint E..., Constraint L...
- Physical Quantities: Task Rule, Estimated R... 0.00, Physical Qu... 0.00, Remaining... 0.00, Actual Phys... 0.00

**3D Model:** The 3D model shows a multi-story building with a central tower and a gabled roof. The model is rendered in a simple, greyish-blue style.



# L'EDILIZIA DEI PROSSIMI 10 ANNI

para|lab  
PH.D ING CARLO ZANCHETTA

Tasks/Task#id	Tasks/Task/Name	Tasks/Task/start	Tasks/Task/Finish	Tasks/Task/Active	Tasks/Task/Active/#agg	Tasks/Task/Actual Cost	Tasks/Task/Actual Cost/#agg	Tasks/Task/ActualDuration	Tasks/Task/ActualFinish	Tasks/Task/ActualOvertimeCost	Tasks/Task/ActualOvertimeCost/#agg	Tasks/Task/ActualOvertimeWork	Tasks/Task/ActualStart	Tasks/Task/ActualWork	Tasks/Task/ACWP	Tasks/Task/ACWP/#agg	Tasks/Task/BCWP	Tasks/Task/BCWP/#agg	Tasks/Task/BCWS	Tasks/Task/BCWS/#agg	Tasks/Task/CalendarUID	Tasks/Task/CalendarUID/#agg	Tasks/Task/CommitmentType	Tasks/Task/CommitmentTime	Tasks/Task/CommitmentTime/#agg
1	Training Project Schedule	01.02.2016 09:00	26.04.2017 17:00	1	1	0	0	PT183H27M12S		0	0	PT0H0M0S	01.02.2016 09:00	PT240H0M0S	0	0	0	0	0	0	1	1	0		
2	Office Building, Core & S	01.02.2016 09:00	26.04.2017 17:00	1	1	0	0	PT183H27M12S		0	0	PT0H0M0S	01.02.2016 09:00	PT240H0M0S	0	0	0	0	0	0	-1	-1	0		
3	Pre Construction	01.02.2016 09:00	26.02.2016 17:00	1	1	0	0	PT160H0M0S	26.02.2016 17:00	0	0	PT0H0M0S	01.02.2016 09:00	PT240H0M0S	0	0	0	0	0	0	1	1	0		
4	Notice to Proceed	01.02.2016 09:00	01.02.2016 09:00	1	1	0	0	PT0H0M0S	01.02.2016 09:00	0	0	PT0H0M0S	01.02.2016 09:00	PT0H0M0S	0	0	0	0	0	0	1	1	0		
5	Building Permit	01.02.2016 09:00	26.02.2016 17:00	1	1	0	0	PT160H0M0S	26.02.2016 17:00	0	0	PT0H0M0S	01.02.2016 09:00	PT160H0M0S	0	0	0	0	0	0	1	1	0		
6	Award Subcontractors	01.02.2016 09:00	12.02.2016 17:00	1	1	0	0	PT80H0M0S	12.02.2016 17:00	0	0	PT0H0M0S	01.02.2016 09:00	PT80H0M0S	0	0	0	0	0	0	1	1	0		
7	Perimeter Fence	22.02.2016 09:00	24.02.2016 17:00	1	1	0	0	PT24H0M0S	24.02.2016 17:00	0	0	PT0H0M0S	22.02.2016 09:00	PT0H0M0S	0	0	0	0	0	0	1	1	0		
8	Temporary Hard Standin	24.02.2016 09:00	24.02.2016 17:00	1	1	0	0	PT8H0M0S	24.02.2016 17:00	0	0	PT0H0M0S	24.02.2016 09:00	PT0H0M0S	0	0	0	0	0	0	1	1	0		
9	Field Office	25.02.2016 09:00	26.02.2016 17:00	1	1	0	0	PT16H0M0S	26.02.2016 17:00	0	0	PT0H0M0S	25.02.2016 09:00	PT0H0M0S	0	0	0	0	0	0	1	1	0		
10	Material Procurement	15.02.2016 09:00	20.05.2016 17:00	1	1	0	0	PT94H46M12S		0	0	PT0H0M0S	15.02.2016 09:00	PT0H0M0S	0	0	0	0	0	0	1	1	0		
11	Structural Steel	15.02.2016 09:00	13.05.2016 17:00	1	1	0	0	PT88H0M0S		0	0	PT0H0M0S	15.02.2016 09:00	PT0H0M0S	0	0	0	0	0	0	1	1	0		
12	Glass Curtain Wall	15.02.2016 09:00	06.05.2016 17:00	1	1	0	0	PT88H0M0S		0	0	PT0H0M0S	15.02.2016 09:00	PT0H0M0S	0	0	0	0	0	0	1	1	0		
13	Elevator	15.02.2016 09:00	13.05.2016 17:00	1	1	0	0	PT88H0M0S		0	0	PT0H0M0S	15.02.2016 09:00	PT0H0M0S	0	0	0	0	0	0	1	1	0		
14	MEP Equipment	15.02.2016 09:00	20.05.2016 17:00	1	1	0	0	PT88H0M0S		0	0	PT0H0M0S	15.02.2016 09:00	PT0H0M0S	0	0	0	0	0	0	1	1	0		
15	Construction	29.02.2016 09:00	21.02.2017 17:00	1	1	0	0	PT5H3M30S		0	0	PT0H0M0S	29.02.2016 09:00	PT0H0M0S	0	0	0	0	0	0	1	1	0		
16	Site Construction	29.02.2016 09:00	07.02.2017 17:00	1	1	0	0	PT29H3M30S		0	0	PT0H0M0S	29.02.2016 09:00	PT0H0M0S	0	0	0	0	0	0	1	1	0		
17	Foundation Excavation	29.02.2016 09:00	04.03.2016 17:00	1	1	0	0	PT8H0M0S		0	0	PT0H0M0S	29.02.2016 09:00	PT0H0M0S	0	0	0	0	0	0	1	1	0		
18	Structural Piles	07.03.2016 09:00	01.04.2016 17:00	1	1	0	0	PT0H0M0S		0	0	PT0H0M0S		PT0H0M0S	0	0	0	0	0	0	1	1	0		
19	Site Utilities	29.02.2016 09:00	22.04.2016 17:00	1	1	0	0	PT8H0M0S		0	0	PT0H0M0S	29.02.2016 09:00	PT0H0M0S	0	0	0	0	0	0	1	1	0		
20	Backfill / Compact Founc	18.04.2016 09:00	22.04.2016 17:00	1	1	0	0	PT0H0M0S		0	0	PT0H0M0S		PT0H0M0S	0	0	0	0	0	0	1	1	0		
21	Crushed Gravel, Ground	11.07.2016 09:00	15.07.2016 17:00	1	1	0	0	PT0H0M0S		0	0	PT0H0M0S		PT0H0M0S	0	0	0	0	0	0	1	1	0		
22	Road / Parking Lot Prepa	21.12.2016 09:00	17.01.2017 17:00	1	1	0	0	PT0H0M0S		0	0	PT0H0M0S		PT0H0M0S	0	0	0	0	0	0	1	1	0		
23	Road / Parking Lot Pavem	18.01.2017 09:00	25.01.2017 17:00	1	1	0	0	PT0H0M0S		0	0	PT0H0M0S		PT0H0M0S	0	0	0	0	0	0	1	1	0		
24	Site Improvements	21.12.2016 09:00	24.01.2017 17:00	1	1	0	0	PT0H0M0S		0	0	PT0H0M0S		PT0H0M0S	0	0	0	0	0	0	1	1	0		
25	Site Plantings	25.01.2017 09:00	07.02.2017 17:00	1	1	0	0	PT0H0M0S		0	0	PT0H0M0S		PT0H0M0S	0	0	0	0	0	0	1	1	0		
26	Concrete	04.04.2016 09:00	04.08.2016 17:00	1	1	0	0	PT0H0M0S		0	0	PT0H0M0S		PT0H0M0S	0	0	0	0	0	0	1	1	0		

Attività ID	Attività Nome	Data inizio	Data fine	Attività Stato
1	Office Building, Core & Shell	01.02.2016 09:00	26.04.2017 17:00	
2	Pre Construction	01.02.2016 09:00	26.02.2016 17:00	
3	Notice to Proceed	01.02.2016 09:00	01.02.2016 09:00	
4	Building Permit	01.02.2016 09:00	26.02.2016 17:00	
5	Award Subcontractors	01.02.2016 09:00	12.02.2016 17:00	
6	Perimeter Fence	22.02.2016 09:00	24.02.2016 17:00	
7	Temporary Hard Standing	24.02.2016 09:00	24.02.2016 17:00	
8	Field Office	25.02.2016 09:00	26.02.2016 17:00	
9	Material Procurement	15.02.2016 09:00	20.05.2016 17:00	
10	Structural Steel	15.02.2016 09:00	13.05.2016 17:00	
11	Glass Curtain Wall	15.02.2016 09:00	06.05.2016 17:00	
12	Elevator	15.02.2016 09:00	13.05.2016 17:00	
13	MEP Equipment	15.02.2016 09:00	20.05.2016 17:00	
14	Construction	29.02.2016 09:00	21.02.2017 17:00	
15	Site Construction	29.02.2016 09:00	07.02.2017 17:00	
16	Foundation Excavation	29.02.2016 09:00	04.03.2016 17:00	
17	Structural Piles	07.03.2016 09:00	01.04.2016 17:00	
18	Site Utilities	29.02.2016 09:00	22.04.2016 17:00	
19	Backfill / Compact Foundation Excavation	18.04.2016 09:00	22.04.2016 17:00	
20	Crushed Gravel, Ground Floor	11.07.2016 09:00	15.07.2016 17:00	
21	Road / Parking Lot Preparation	21.12.2016 09:00	17.01.2017 17:00	
22	Road / Parking Lot Pavement	18.01.2017 09:00	25.01.2017 17:00	
23	Site Improvements	21.12.2016 09:00	24.01.2017 17:00	
24	Site Plantings	25.01.2017 09:00	07.02.2017 17:00	
25	Concrete	04.04.2016 09:00	04.08.2016 17:00	
26	Pile Caps	04.04.2016 09:00	15.04.2016 17:00	
27	Grade Beams	25.04.2016 09:00	06.05.2016 17:00	
28	Slab on Grade	18.07.2016 09:00	20.07.2016 17:00	
29	Slab on Deck, 1st Floor	21.07.2016 09:00	02.08.2016 17:00	
30	Slab on Deck, 1st Floor, Area 1	21.07.2016 09:00	26.07.2016 17:00	
31	Slab on Deck, 1st Floor, Area 1A	21.07.2016 09:00	21.07.2016 17:00	
32	Slab on Deck, 1st Floor, Area 1B	22.07.2016 09:00	22.07.2016 17:00	
33	Slab on Deck, 1st Floor, Area 1C	25.07.2016 09:00	25.07.2016 17:00	
34	Slab on Deck, 1st Floor, Area 1D	26.07.2016 09:00	26.07.2016 17:00	

Programma lavori su Google Drive

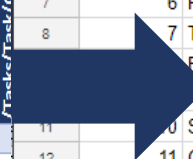

# L'EDILIZIA DEI PROSSIMI 10 ANNI

parallab  
PH.D ING CARLO ZANCHETTA



**APP Inventor**

**Programma lavoro**

**Google Drive**

**APP**

Attività ID	Attività Nome	Data inizio	Data fine	Attività Stato
01.01	nome1	29/05/2018	29/05/2018	Attiva
01.02	nome2	29/05/2018	29/05/2018	Completata
02.02	nome3	29/05/2018	29/05/2018	Completata
03.01	nome4	28/05/2018	30/05/2018	Attiva

# L'EDILIZIA DEI PROSSIMI 10 ANNI

L'applicazione **registra** il  
**giornale** dei **comportamenti** e le **attività**



La DL registra il **completamento**

Attività_ID	Attività_Nome	Data inizio	Data fine	Attività_Stato
01 01	nome1	28/5/2018	29/5/2018	Attiva
01 02	nome2	28/5	6/1	Completata
02 01	nome3	28/5	4/1	Completata
02 02	nome4	4/1	8/1	Attiva
03 01	fine	28/5	30/5	Attiva

# L'EDILIZIA DEI PROSSIMI 10 ANNI

parallab  
PH.D ING CARLO ZANCHETTA



CASO STUDIO



TeamSystem

SYNCHRO

parallab

BIM & APP

## PARTNERS





# edilportale<sup>®</sup>

## TOUR 2019

grazie per l'attenzione

[carlo.zanchetta@unipd.it](mailto:carlo.zanchetta@unipd.it)

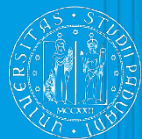

[it.linkedin.com/pub/carlo-zanchetta](https://it.linkedin.com/pub/carlo-zanchetta)



[info@parallab.com](mailto:info@parallab.com)

